

Product Features

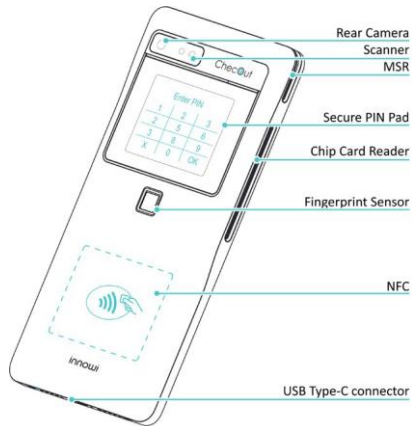
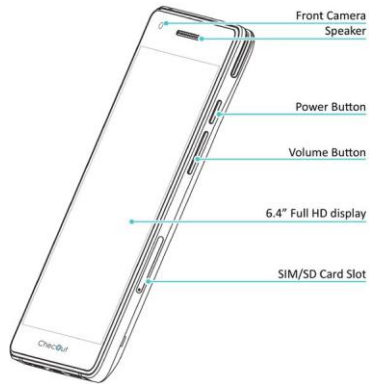

This device complies with Part 15 of the FCC Rules. Operation is subject to the following two conditions: (1) this device may not cause harmful interference and (2) this device must accept any interference received, including interference that may cause undesired operation.

Note: This equipment has been tested and found to comply with the limits for a device, pursuant to Part 15 of the FCC Rules. These limits are designed to provide reasonable protection against harmful interference. This equipment generates, uses and can radiate radio frequency energy and, if not installed and used in accordance with the instructions, may cause harmful interference to radio communications.

Caution: Changes or modifications not approved by Innowi could void the user's authority to operate the device.

FCC RF Exposure Information (SAR)

This device is designed and manufactured not to exceed the emission limits for exposure to radio frequency (RF) energy set by the Federal Communications Commission of the United States.

During SAR testing, this device is set to transmit at its highest certified power level in all tested frequency bands and placed in positions that simulate RF exposure in usage near the body. Although the SAR is determined at the highest certified power level, the actual SAR level of the device while operating can be well below the maximum value. This is because the device is designed to operate at multiple power levels so as to use only the power required to reach the network.

ChecOut™ M

Quick Start Guide

Smart. Secure. Sophisticated. Simplified.

Operation Instructions

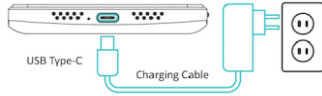

1. Connect the power adapter cable to the ChecOut M USB-C connector and plug-in to the wall socket.
2. Turn on the device by pressing the power button for a few seconds. You will see the "ChecOut" display screen turns on and the device begins to power up.
3. From settings menu, Scanning and Payment functionalities can be turned on/ off. Wait for a few seconds before start using scanning and payment functionalities.
4. Use only Innowi provided chargers, batteries, and cables. Non-Innowi chargers or cables can cause the battery to explode or damage the device.
5. When charging ChecOut M device using USB charger or Charging Dock, remove the device from charging once device is fully charged.
6. If the device is not in operation, fully charge the device, remove it from charging and power off the device completely.
7. For questions related to POS applications, payment gateway or payment processing please contact your provider.

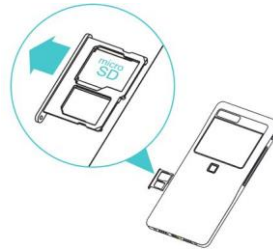

1. Insert SD card ejection tool or a paper clip into the small hole to remove the SD card.
2. Remove the SD Card tray from the ChecOut M device. When reinserting the SD card ensure that it is in the proper orientation relative to the tray.

Recommended Usage

We recommend you hold the ChecOut M in your non-dominant hand while using your dominant hand to take the payments and to carry out other standard device operations.



Scanner Operation

Point the ChecOut M device towards the barcode on an item to scan. For best results keep the ChecOut M device within 6-10 inches from the barcode.



Payment Methods

ChecOut M Tablet can be used to take payments using MSR, Chip Card and NFC as shown in the picture below

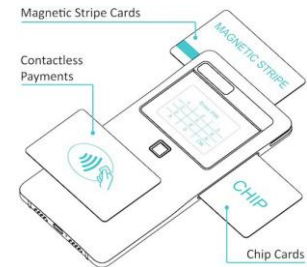

Support

For any questions and comments, please contact your provider or Innowi at support@innowi.com.